

I.135

Revolving handles

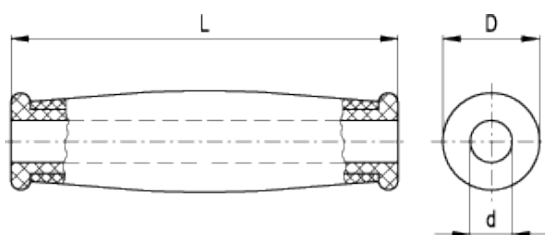

technical informations

Material

Phenolic based (PF) Duroplast. Resistant to solvents, oils, greases and other chemical agents.

Colour

Black, glossy finish.

Assembly

Plain through hole with polyamide based (PA) technopolymer guide bosses in both ends.

Standard Elements		Main dimensions			Weight
Code	Description	L	D	d	g
19001	I.135/120-10	120	30	10	77
19002	I.135/120-11	120	30	11	76
19003	I.135/120-13	120	30	13	74



drawings.

STANDARD MACHINE ELEMENTS WORLDWIDE